

Seine Fluorescent Fixture

Model: GB1216-SS-IBX, GB1217-SS-IBX

To Begin

WARNING: Review important safety instructions before installation. Check to make sure you have the following:

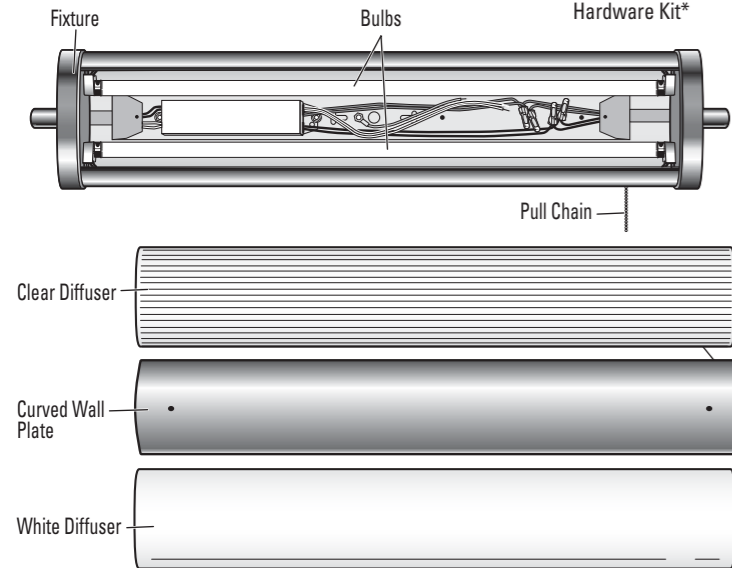
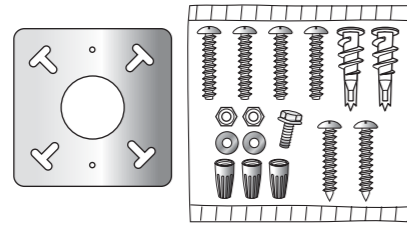

*Actual hardware may differ from illustration.

Required

Installation Time: 45 Minutes

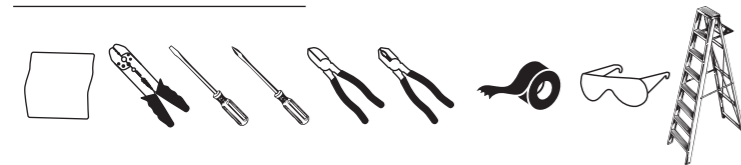

Preparation

DO NOT USE THIS FIXTURE WITH A DIMMING CIRCUIT. If you presently have dimmer controls, you will need to remove them, and replace them with regular electrical switches. If you have a three way dimmer, you will have to replace it with a regular three way switch. **If you are unfamiliar with electrical installations, we recommend you have a qualified electrician do your installation.**

WARNING: Shut off power at the circuit breaker or fuse panel before removing the old fixture (Fig. 1).

- Fig. 1** Remove the old fixture. Make yourself a sketch of how the fixture is wired (index the sketch by wire color) or mark the wires themselves with masking tape and a pencil so you will know how to connect the wires to your new fixture (Fig. 2). If several wires are involved or if the wiring seems more complicated and perhaps even includes a red wire, take note of the connections before you disconnect them.

SAVE THESE INSTRUCTIONS
DO NOT ATTEMPT TO ASSEMBLE THIS LAMP WHILE IT IS PLUGGED IN. THIS LAMP IS FOR INDOOR USE ONLY.
IMPORTANT: Fluorescent bulbs are included with your light fixture. In order to protect the bulb during shipment, your bulb(s) may be packed in a separate area of the packing materials. Additionally, your bulbs may already be placed into their respective sockets, but may have a protective support collar slipped over the bulb. Do **NOT** operate your fixture with this support collar in place. You can either cut this collar off, or remove the bulb from the sockets, and slide the support collar off the bulb. Discard the support collar.
IMPORTANT: The installation of this fixture will require you to provide a means of holding the fixture in place while securing the fixture to the mounting surface. If no means of support for the fixture can be provided, the installation will require 2 people to install; one to hold the fixture up, while another person secures the fixture to the mounting surface.

Fixture Installation

- Depending on the type of electrical box in your installation, you will need to modify the mounting cover plate by removing knockouts that correspond to the mounting screws on your electrical box (Fig. 1).
- Pull your supply wires through the center hole of the electrical box cover and attach the cover to your electrical box using the screws that came with your electrical box (Fig. 2).
- Position the bath bar over the electrical box cover plate, and pull the supply wires through the center hole of the bath bar (Fig. 3). Using the machine screws supplied in your hardware mounting kit, secure the bath bar onto the electrical box cover plate. Check to make sure your bath bar is level and tighten the mounting screws. **NOTE:** Removing the diffusers and bulbs will make attaching and wiring the fixture easier.
- Note:** Additional support may be needed for fixtures longer than 30 inches. If this applies, you should mark and install the plastic anchors in your wall before final mounting of the back-plate (Fig. 4). The plastic anchors should align with the narrow portion of the keyhole slots in your back plate.

WALL STUD MOUNTING
 For mounting over the wall stud, drill two small pilot holes for the screws. Screw both wood screws into the wooden studs (Fig. 5). Approximately 1/2 in. of the screw should still be protruding from the wall.

DRYWALL MOUNTING
 For mounting into drywall, drill 3/16 in. holes for the plastic wall anchors. Insert the plastic wall anchors into the proper holes and screw them into place so they are flush with the surface of your drywall (Fig. 6). Screw all screws into the plastic anchors. Approximately 1/2 in. of the screw should still be protruding from the wall.

For safety and proper operation, your fixture must be properly grounded. If you are unfamiliar with the methods of properly grounding your fixture, consult a qualified electrician. A green insulated copper ground wire is pre-attached to the fixture chassis. If your electrical box is plastic and has a green or bare copper grounding wire inside, the bare end of the fixture grounding wire must be secured to the green grounding wire inside your electrical box using the small wire nut (Fig. 7). If your electrical box is metal and contains no ground wire as part of a grounded electrical system, you need not do anything more, as the metal chassis will be grounded via the electrical box mounting screws.

Connect the supply leads from the electrical box to the fixture wire leads using the medium-sized wire nuts supplied in your installation hardware kit as per the illustration (Fig. 8). The black leads from the fixture go to the black supply lead and the white leads from the fixture go to the white supply lead. Tighten the wire nuts properly to prevent the wires from coming loose. Tape the wire nuts to the wire using electrical tape. Carefully push any excess wiring back inside the electrical box.

Attach the curved wall panel to the fixture chassis using the decorative ball screws (Fig. 9).

If you have not yet done so, using a screwdriver, pry off one of the diffuser panels to access the bulb compartment to check whether your bulbs have protective packaging around them (Fig. 10).

Remove the protective bulb packaging, described earlier in these instructions prior to operating your fixture (Fig. 11). Reattach the diffuser panel after all protective material has been removed. Do **NOT** operate your fixture with the packaging in place.

Remove the protective bulb packaging, described earlier in these instructions prior to operating your fixture (Fig. 11). Reattach the diffuser panel after all protective material has been removed. Do **NOT** operate your fixture with the packaging in place.

Remove the protective bulb packaging, described earlier in these instructions prior to operating your fixture (Fig. 11). Reattach the diffuser panel after all protective material has been removed. Do **NOT** operate your fixture with the packaging in place.

- Restore power to the electrical box to make sure your fixture is working properly.
- The fixture has a unique feature that allows you to swivel the light head in order to adjust the amount and direction of the light (Fig. 12). One diffuser panel is white and the other is clear. The fixture is designed to allow either diffuser to face up or down. **WARNING: DO NOT** attempt to swivel the light head beyond the built-in stop. The rotation of the light head is limited to approximately 350 degrees.
 To turn the fixture on or off, pull the pull chain straight down.

Bulb Replacement Instructions

When bulb replacement is necessary, you must replace the bulb as follows: **21 W/120 volt/ F21T5/10,000 hour bulb life/CCT-3500K fluorescent bulbs (GB1216-SS-IBX) or 28 W/120 volt/ F28T5/10,000 hour bulb life/CCT-3500K fluorescent bulbs (GB1217-SS-IBX).** These bulbs are readily available at your local home center, electrical distributor, and most larger hardware stores.

- Shut off power supply. Allow sufficient time for bulbs to cool properly before handling.
- Pry the diffuser panel off the light head (Fig. 1).
 When replacing a defective bulb, use your thumbs to press and roll the bulb 90 degrees inside the socket (Fig. 2). This will disengage the bulb contact pins from the socket contacts. Then slide the bulb pins out of the socket slot. Install the new bulb(s) into the sockets by aligning the pins of the bulb with the slot in the sockets. Using your thumbs, press the metal ends of the bulb into the socket, and roll the bulb toward the socket until it rotates 90 degrees inside the socket, making contact between the lamp pins, and the socket contacts (Fig. 3). Re-install the diffuser. Restore power to the fixture.

Troubleshooting Guide

Minor problems often can be fixed without the help of an electrician. Before doing any work on the fixture, shut off power supply at the circuit breaker panel to avoid electrical shock.

Problem	Cause	Solution
Fixture doesn't light	Bulb is defective	Replace bulb
	Power is off	Check if power supply is on
	Bad wire connection	Check wiring
	Bad switch	Test or replace switch
Fuse blows or circuit breaker trips when light is turned on	Crossed wires or power wire is grounded out	Check wiring connections

Cleaning Instructions

Your fixture is made from quality materials that will last for many, many years with minimum care. You may want to periodically clean the diffuser, or interior of the fixture using a mild, non-abrasive glass cleaner and soft cloth. Do **NOT** use solvents, or cleaners containing abrasive agents. When cleaning the inside of the fixture, make sure you have the power turned off, and do not spray liquid cleaner directly onto the bulb, socket, ballast, or wiring.

In the unlikely event that your fixture's ballast, or lamp socket(s) fail, they can be replaced by a qualified electrician. For further information regarding these replaceable parts, please have your electrician contact our technical support number at 1-866-455-4798.

Replacement Parts List

Keep this guide handy for ordering replacement parts.

Hardware Kit	
HDW1216	
HDW1217	
Diffuser	
D1216W	
D1217W	
D1216C	
D1217C	

Need Help?



In the event you are missing a part or have questions regarding installation please visit our website at www.goodearthlighting.com/support.html or call the Customer Care Center 1-866-455-4798.

Warranty

2 YEAR LIMITED WARRANTY

Good Earth Lighting, Inc. warrants this lighting fixture to be free from defects in materials and workmanship for a period of two (2) years from the date of original purchase by the consumer.

If you are missing any parts, or have any questions about your installation, **DO NOT RETURN YOUR FIXTURE TO THE STORE! CALL US FIRST!** We can often help get the problem corrected right over the phone. You can call us at 1-866-455-4798, 9AM-5PM CST, Monday through Friday.

In the unlikely event the Good Earth Lighting fixture fails to perform as it was designed to do within two (2) years from date of purchase, we will repair or replace (at our option) the unit in the original color, and style if available, or in a similar color and style if the original item has been discontinued, without charge. This warranty covers the entire fixture, **EXCLUSIVE OF LAMPS.** Suspect units should be properly checked to ensure performance problems are not lamp related. Defective units must be properly packed, and returned to Good Earth Lighting, Inc. with a letter of explanation, and your original purchase receipt showing date of purchase. **Call us at 1-866-455-4798** to obtain a Return Authorization number, and an address where to ship your defective product.

Note: No C.O.D. shipments will be accepted. The liability of Good Earth Lighting, Inc. is in any case limited to replacement of the defective light fixture product. Good Earth Lighting, Inc. will not be liable for any other loss, damage, or injury which is caused by the product. This limitation upon the liability of Good Earth Lighting, Inc. includes any loss, damage, or injury which is (I) to person or property or otherwise; (II) incidental or consequential in nature; (III) based upon theories of warranty, contact, negligence, strict liability, tort, or otherwise; or (IV) directly, or indirectly related to the sale, use, or repair of the product.

Good Earth Lighting, Inc., 5260 Capitol Drive, Wheeling, IL 60090

Printed in China



Lamp contains Mercury. Dispose according to local, state, or Federal laws. See: www.lamprecycle.org

MIN 90°C SUPPLY CONDUCTORS
 CONSULT A QUALIFIED ELECTRICIAN TO ENSURE CORRECT BRANCH CIRCUIT CONDUCTOR

©2013 Good Earth Lighting, Inc.
 HDS3813INS12161217