

# Patriot

## LIGHTING®

### Legend 11" LED Sconce

Model #: SC1127-NK7-11LF0-T

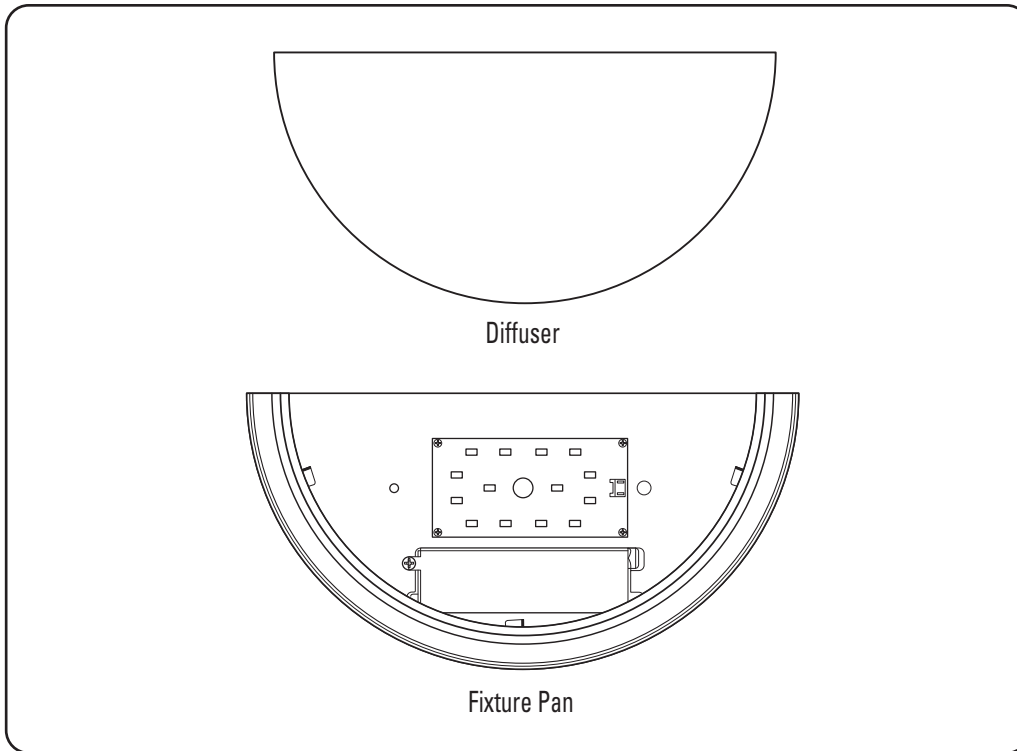

#### Hardware kit\*

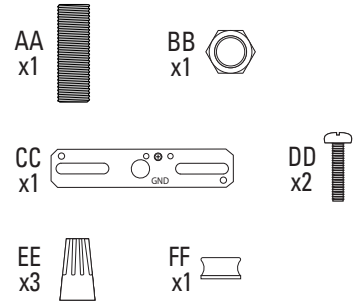

\*Actual hardware may differ from illustration

#### Required

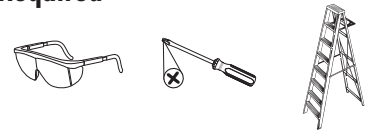

#### Need Help?

Questions? Call our Customer Service Center 1-800-291-8838.



## Warnings and Cautions

Shut off power at the circuit breaker or fuse panel before removing the old fixture or installing the new one.

LEDs can be damaged by electrostatic discharge shock. Before installation, discharge yourself by touching a grounded bare metal surface to remove this hazard.

For **INDOOR** use only. For electrical requirements, see fixture. Minimum 90° C supply conductors.

**THIS FIXTURE IS DIMMABLE BY SPECIFIC FORWARD PHASE ELECTRONIC (TRAIC) DIMMERS AND IS NOT COMPATIBLE WITH 0-10V DIMMING SYSTEMS.** Dimmers tested to be compatible with this fixture are the Lutron® Diva® C•L™: DVVCL-153P or DVCL-153P, Lumea® C•L™: LGCL-153P, and Toggler® C•L™: TGCL-153P. (This list of dimmers does not imply any guarantee or warranty of compatibility with a particular application. Dimmers not listed do not imply non-compatibility.)

If unsure if the electrical box is properly grounded, or the box is plastic and has no ground wire, or are unfamiliar with the methods of properly grounding fixture, consult a qualified electrician.

Do **NOT** use solvents or cleaners containing abrasive agents. Do not spray liquid cleaner directly onto the LEDs, fixture, diffuser, or wiring.

This device complies with Part 15 of the FCC rules. Operation is subject to the following two conditions: (1) This device may not cause harmful interference, and (2) this device must accept any interference received, including interference that may cause undesired operation. Warning: Changes or modifications to this unit not expressly approved by the party responsible for compliance could void the user's authority to operate the equipment. NOTE: This equipment has been tested and found to comply with the limits for a Class B digital device, pursuant to Part 15 of the FCC Rules. These limits are designed to provide reasonable protection against harmful interference in a residential installation. This equipment generates, uses and can radiate radio frequency energy and, if not installed and used in accordance with the instructions, may cause harmful interference to radio communications. However, there is no guarantee that interference will not occur in a particular installation. If this equipment does cause harmful interference to radio or television reception, which can be determined by turning the equipment off and on, the user is encouraged to try to correct the interference by one or more of the following measures: Reorient or relocate the receiving antenna. Increase the separation between the equipment and receiver. Connect the equipment into an outlet on a circuit different from that to which the receiver is connected. Consult the dealer or an experienced radio/TV technician for help.

## Patriot Lighting® Warranty

**FIVE-YEAR LIMITED WARRANTY:** If, during normal use, this PATRIOT LIGHTING® lighting fixture breaks or fails due to a defect in material and workmanship within five (5) years from the date of original purchase, simply bring this lighting fixture with the original sales receipt back to your nearest MENARDS® retail store. At its discretion, PATRIOT LIGHTING® agrees to have the product or any defective part(s) repaired or replaced with the same or similar PATRIOT LIGHTING® product or part free of charge, within the stated warranty period, when returned by the original purchaser with the original sales receipt. This warranty; (1) excludes expendable parts including but not limited to light bulbs; (2) does not cover damage that has resulted from abuse or misuse; and (3) does not cover any losses, labor, injuries to persons/property or costs. This warranty does give you specific legal rights and you may have other rights, which vary from state to state.

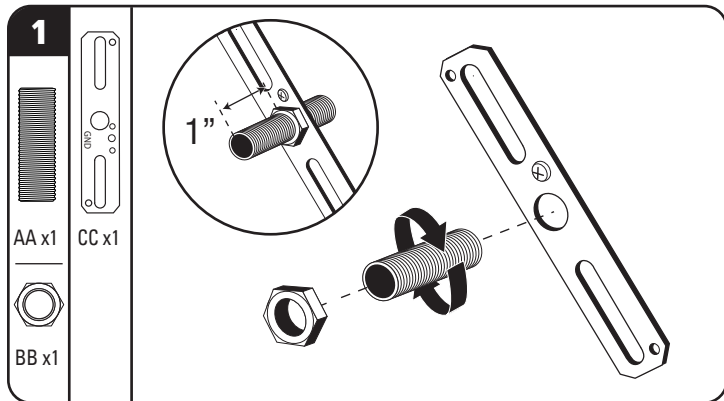

**1** Attach threaded tube (AA) to threaded hole in mounting bracket (CC). Lock in place using hex nut (BB). Threaded tube should extend about an inch beyond wall line.

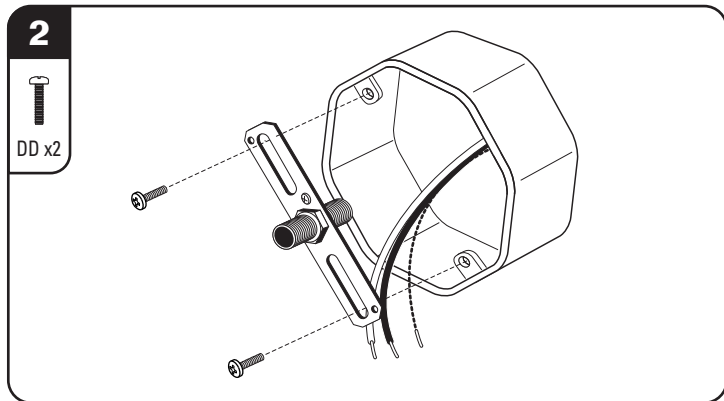

**2** Attach mounting bracket to electrical box using mounting screws (DD) or existing electrical box screws.

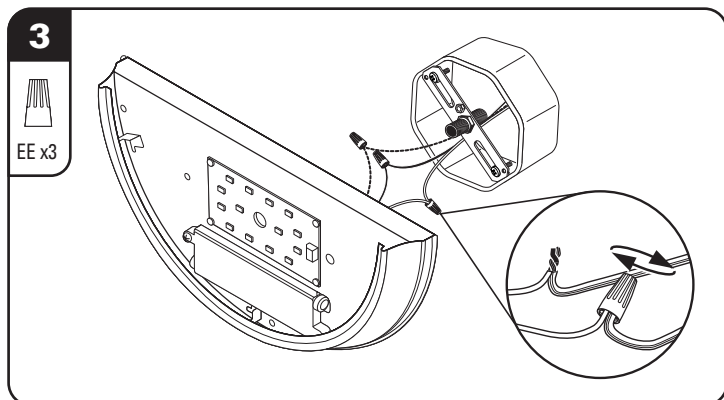

**3** Fixture must be properly grounded. Connect fixture ground wire to ground wire in electrical box using a wire nut (EE). Ground wires can be either green or bare copper. Connect black supply lead to black fixture wire and white supply lead to white fixture wire using wire nuts (EE). Secure the wire nuts properly to prevent the wires from coming loose. Push excess wire back into the electrical box.

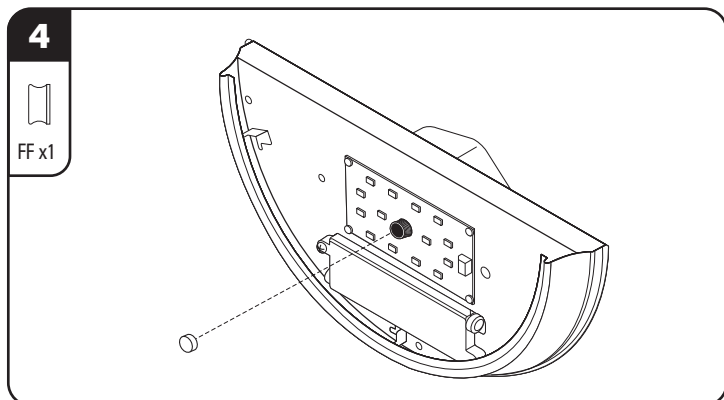

**4** Attach fixture pan to the electrical box by aligning threaded tube through the center of fixture pan. Secure fixture using screw cap (FF). **Note:** If necessary, adjust the depth of the threaded tube to ensure fixture is held tight against the wall.

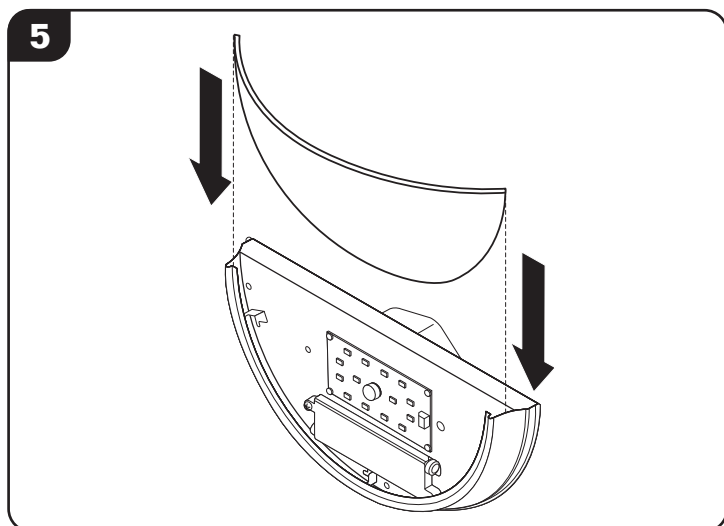

**5** Slide the diffuser into the frame of the fixture. Once the diffuser is set into the frame, carefully adjust it into place until it is securely seated and aligned with the top of the frame. Restore power to the fixture.

### Troubleshooting Guide

Before doing any work on the fixture, shut off power supply at the circuit breaker panel to avoid electrical shock.

Problem	Cause	Solution
Fixture doesn't light.	Power is off. Bad connection. Bad switch.	Check if power supply is on. Check cords and/or wiring. Test or replace switch.
Fuse blows or circuit breaker trips when light is turned on.	Discontinue use.	Call <b>Customer Service Center 1-800-291-8838</b> .

### Replacement Parts List

Hardware Kit:  
ZH-SC1127D11-NK7  
Replacement Diffuser:  
ZD-SC1127D11-OPL

**SAVE THESE INSTRUCTIONS.**