

Hardware kit*

AA
x2

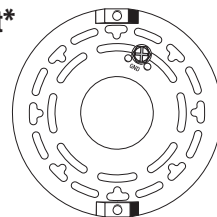

BB
x1



CC
x2



DD
x2



EE
x3



FF
x2



GG
x2



*Actual hardware may differ from illustration

Required



1/8 in.



Need Help?

Questions? Call our Customer Service Center 1-800-291-8838.



Warnings and Cautions

Shut off power at the circuit breaker or fuse panel before removing the old fixture or installing the new one.

LEDs can be damaged by electrostatic discharge shock. Before installation, discharge yourself by touching a grounded bare metal surface to remove this hazard.

For **INDOOR** use only. For electrical requirements, see fixture. Minimum 90° C supply conductors.

THIS FIXTURE IS DIMMABLE BY SPECIFIC FORWARD PHASE ELECTRONIC (TRAIC) DIMMERS AND IS NOT COMPATIBLE WITH 0-10V DIMMING SYSTEMS. Dimmers tested to be compatible with this fixture are the Lutron® Diva® C•L™: DVVCL-153P or DVCL-153P, Lumea® C•L™: LGCL-153P, and Toggler® C•L™: TGCL-153P. (This list of dimmers does not imply any guarantee or warranty of compatibility with a particular application. Dimmers not listed do not imply non-compatibility.)

If unsure if the electrical box is properly grounded, or the box is plastic and has no ground wire, or are unfamiliar with the methods of properly grounding fixture, consult a qualified electrician.

Do **NOT** use solvents or cleaners containing abrasive agents. Do not spray liquid cleaner directly onto the LEDs, fixture, diffuser, or wiring.

This device complies with Part 15 of the FCC rules. Operation is subject to the following two conditions: (1) This device may not cause harmful interference, and (2) this device must accept any interference received, including interference that may cause undesired operation. Warning: Changes or modifications to this unit not expressly approved by the party responsible for compliance could void the user's authority to operate the equipment. NOTE: This equipment has been tested and found to comply with the limits for a Class B digital device, pursuant to Part 15 of the FCC Rules. These limits are designed to provide reasonable protection against harmful interference in a residential installation. This equipment generates, uses and can radiate radio frequency energy and, if not installed and used in accordance with the instructions, may cause harmful interference to radio communications. However, there is no guarantee that interference will not occur in a particular installation. If this equipment does cause harmful interference to radio or television reception, which can be determined by turning the equipment off and on, the user is encouraged to try to correct the interference by one or more of the following measures: Reorient or relocate the receiving antenna. Increase the separation between the equipment and receiver. Connect the equipment into an outlet on a circuit different from that to which the receiver is connected. Consult the dealer or an experienced radio/TV technician for help.

Patriot Lighting® Warranty

FIVE-YEAR LIMITED WARRANTY: If, during normal use, this PATRIOT LIGHTING® lighting fixture breaks or fails due to a defect in material and workmanship within five (5) years from the date of original purchase, simply bring this lighting fixture with the original sales receipt back to your nearest MENARDS® retail store. At its discretion, PATRIOT LIGHTING® agrees to have the product or any defective part(s) repaired or replaced with the same or similar PATRIOT LIGHTING® product or part free of charge, within the stated warranty period, when returned by the original purchaser with the original sales receipt. This warranty; (1) excludes expendable parts including but not limited to light bulbs; (2) does not cover damage that has resulted from abuse or misuse; and (3) does not cover any losses, labor, injuries to persons/property or costs. This warranty does give you specific legal rights and you may have other rights, which vary from state to state.

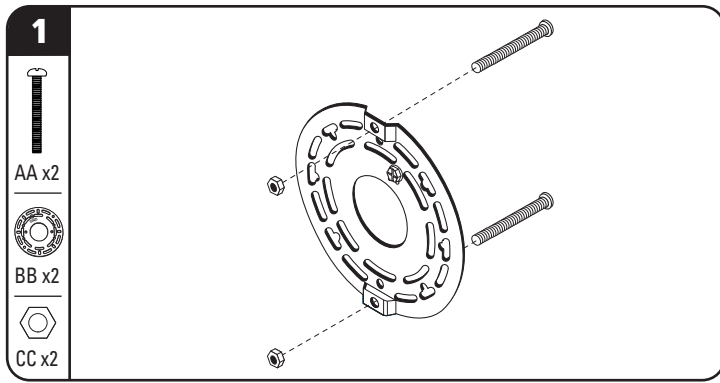

- 1 Screw the two long machine screws (**AA**) through the threaded holes from the backside of the mounting bracket (**BB**). On the front side of the mounting bracket, secure the hex nuts (**CC**) onto the screws until they are flush with the mounting bracket.
- 2 Hold the mounting bracket up to the electrical box and pull the wires through the center opening of the mounting bracket. Use the short machine screws (**DD**) to attach the mounting bracket flush to the electrical box.
NOTE: If necessary, the elongated slots in the mounting bracket may be utilized to achieve the correct orientation for the installation.

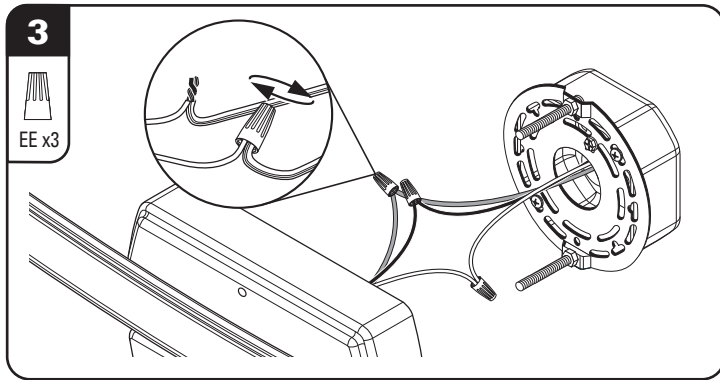
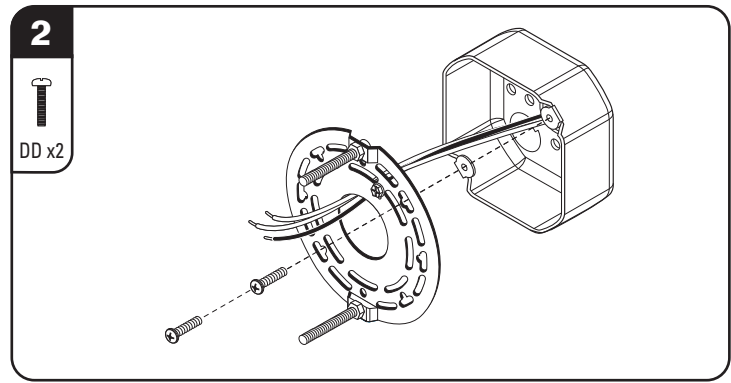

- 3 Fixture must be properly grounded. Connect fixture ground wire to ground wire in electrical box using a wire nut (**EE**). The ground wires can be either green or bare copper. Connect black supply lead to black fixture wire and white supply lead to white fixture wire using wire nuts (**EE**). Secure the wire nuts properly to prevent the wires from coming loose. Push excess wire back into the electrical box.
- 4 Before mounting fixture, make sure the closed catches on the endcaps are on the bottom to prevent the diffuser from falling out of the end caps. Secure the fixture to the electrical box with the screw caps (**FF**). The back plate should be tight against the wall surface.

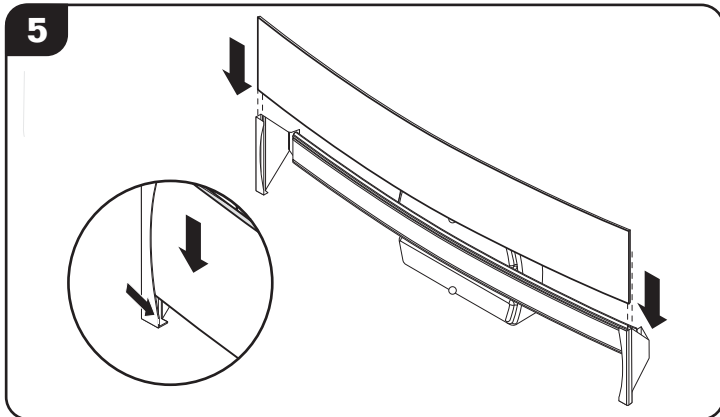
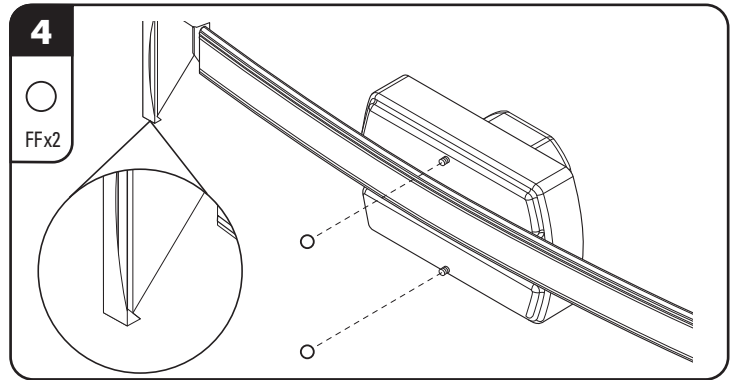

- 5 Simultaneously, slide both ends of the diffuser evenly into the channels of each end caps. **NOTE:** If the diffuser will not line up with the channels, it may be necessary to adjust the end caps by carefully bending them in or out as needed. Once both ends of the diffuser are set in the openings of the end caps carefully push/pull the diffuser into place until it is securely seated in the closed catches.
- 6 In order to hold the glass in place, insert the silicone pads (**GG**) between the diffuser and the end cap channel at each end. Restore power to the fixture.

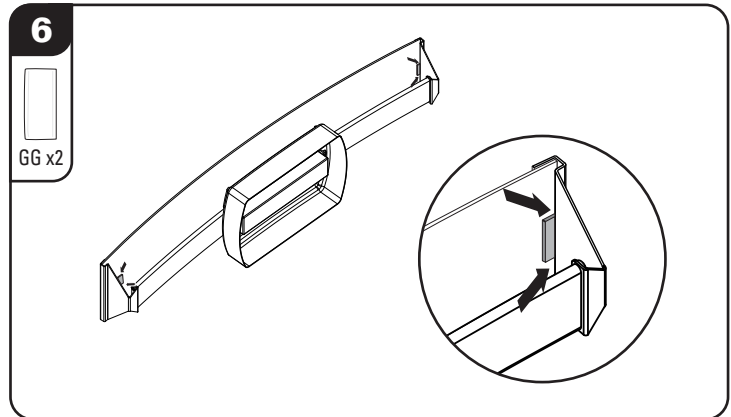

Troubleshooting Guide

Before doing any work on the fixture, shut off power supply at the circuit breaker panel to avoid electrical shock.

Problem	Cause	Solution
Fixture doesn't light.	Power is off. Bad connection. Bad switch.	Check if power supply is on. Check cords and/or wiring. Test or replace switch.
Fuse blows or circuit breaker trips when light is turned on.	Discontinue use.	Call Customer Service Center: 1-800-291-8838.

Replacement Parts List

Hardware Kit:
ZH-VA1126D24-NK3

Replacement Diffuser:
ZD-VA1126D24-WHF

SAVE THESE INSTRUCTIONS.