

Hardware kit*
Trousse de quincaillerie*
Kit de aditamentos*

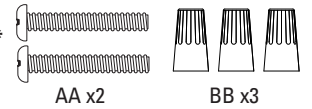

*Actual hardware may differ from illustration
 *Les éléments de fixation réels peuvent être différents de ceux de l'illustration.
 *Los herrajes reales pueden diferir de los que se muestran en la ilustración

Required
Nécessaire
Obligatorio

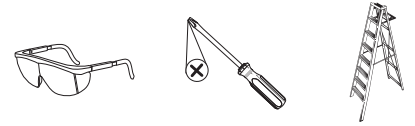

⚠ WARNINGS AND CAUTIONS

SHUT OFF POWER AT THE CIRCUIT BREAKER OR FUSE PANEL BEFORE REMOVING THE OLD FIXTURE AND/OR INSTALLING A NEW ONE.

Read entire installation procedure before you begin and save instructions for future reference.

THIS FIXTURE IS DIMMABLE BY SPECIFIC FORWARD PHASE ELECTRONIC (TRIAC) DIMMERS. Dimmers tested to be compatible with this fixture are the Lutron Diva[®] DVCL-153P*, Maestro[®] MACL-153M*, Toggler[®] TGCL-153P*. (This list of dimmers does not imply any guarantee or warranty of compatibility with a particular application. Dimmers not listed do not imply non-compatibility.)

If unsure whether the electrical box is properly grounded, or the box is plastic and has no ground wire, or are unfamiliar with the methods of properly grounding fixture, consult a qualified electrician.

Important Safety Information

1. Do not look directly at LEDs for extended period of time.
2. Suitable for **INDOOR** damp locations.
3. Turn power off before servicing.
4. Do not leave bare wires exposed.
5. Use Minimum 90 °C supply conductors. For additional electrical requirements, see fixture.
6. DO NOT alter this fixture. It is not manufactured with replaceable or serviceable parts.

Care and Maintenance

Periodically clean the fixture and diffuser using a mild, non-abrasive cleaner and soft cloth. When cleaning the fixture, make sure the power is turned off. Do not spray cleaner directly onto any part of the fixture or LEDs.

⚠ TURN POWER OFF AT BREAKER BOX/FUSE BOX. TURN WALL SWITCH TO JUNCTION BOX OFF

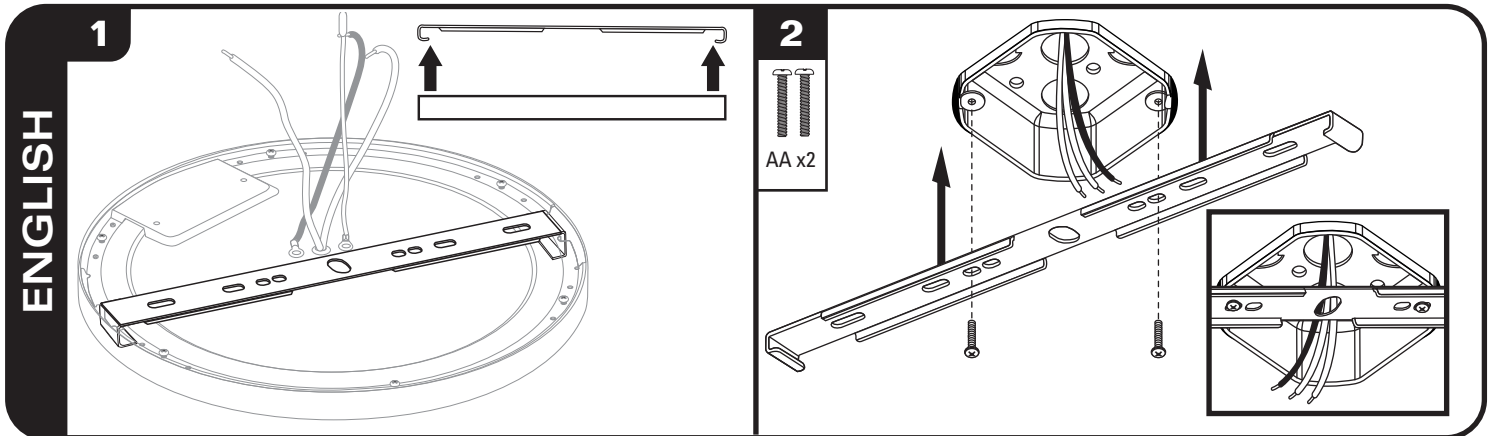

- 1 To remove the mounting bracket, twist to unlock from the fixture.
- 2 Using the box screws (AA), secure the mounting bracket to the junction box (J-Box).

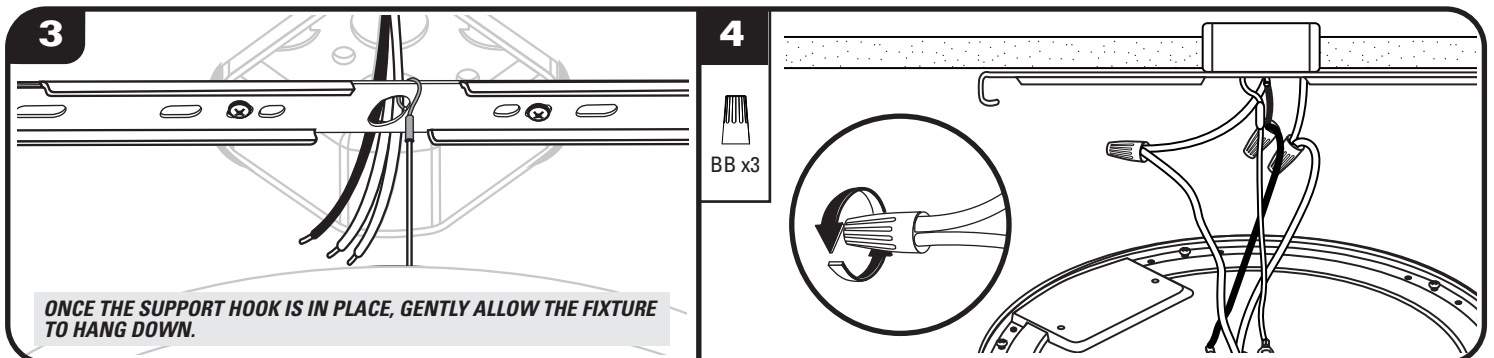

- 3 To make installation easier, a pre-attached support wire is located on the back of the fixture. Attach the hook end through the center hole of the mounting bracket to suspend the fixture in place while the wire connections are made.
- 4 Fixture must be properly grounded. Ground wires are usually either green or bare copper. Connect the fixture ground wire to the ground wire from the J-box using a wire nut (BB). Connect the black supply lead (HOT) to the black fixture wire; and the white supply lead (NEUTRAL) to the white fixture wire using wire nuts (BB). Secure the wire nuts properly to prevent the wires from coming loose. Push excess wire back into the J-box.