

**Hardware kit\* / Kit de aditamentos\***

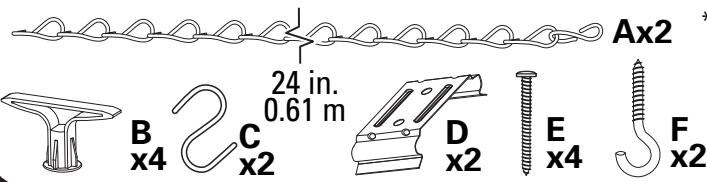

\* Actual hardware may differ from illustration.  
\* Es posible que los herrajes reales difieran de los de la ilustración.

**Required  
Se requiere**

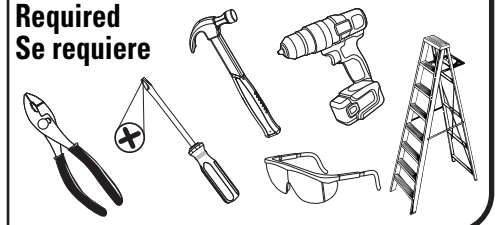

Read entire installation procedure before you begin and save instruction for future reference

**ENGLISH**

**⚠ WARNINGS & CAUTIONS**

1. DO NOT ATTEMPT TO INSTALL LIGHT BAR WHILE PLUGGED IN.
2. Maximum number of fixtures per run must not exceed power supply wattage rating Maximum 500W (link up to 5 fixtures total).
3. Do not use an extension cord: Use power strips with integral overcurrent protection.
4. Do not look directly at LED for extended period of time.
5. Route and secure the cords so that they will not be pinched or damaged.
6. Operate in areas ranging between -20° to 104°F (-29° to 40° C).
7. For dry indoor locations.
8. DO NOT USE THIS FIXTURE WITH A DIMMING CIRCUIT.
9. Turn power off before servicing.
10. Do NOT mount to surfaces less than 1/4 in.
11. Do NOT mount over sinks or stoves.
12. Electrical requirements can be found on back of fixture.

**FCC STATEMENT:** This device complies with Part 15 of the FCC rules. Operation is subject to the following two conditions: (1) This device may not cause harmful interference, and (2) this device must accept any interference received, including interference that may cause undesired operation. Warning: Changes or modifications to this unit not expressly approved by the party responsible for compliance could void the user's authority to operate the equipment. Note: This equipment has been tested and found to comply with the limits for a Class B digital device, pursuant to Part 15 of the FCC rules. These limits are designed to provide reasonable protection against harmful interference in a residential installation. This equipment generates, uses and can radiate radio frequency energy and, if not installed and used in accordance with the instructions, may cause harmful interference to radio communications. However, there is no guarantee that the interference will not occur in a particular installation. If this equipment does cause harmful interference to radio or television reception, which can be determined by turning the equipment off and on, the user is encouraged to try to correct the interference by one or more of the following measures: 1) Reorient or relocate the receiving antenna. 2) Increase the separation between the equipment and receiver. 3) Connect the equipment into an outlet on a circuit different from that of the receiver. 4) Consult the dealer or an experienced radio/TV technician for help.

**DO NOT plug-in fixture prior to installation. Select a mounting location within 5 feet of an electrical outlet.**

**Chain Installation**

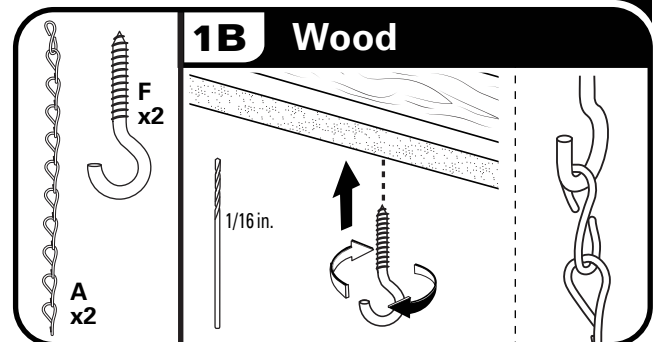
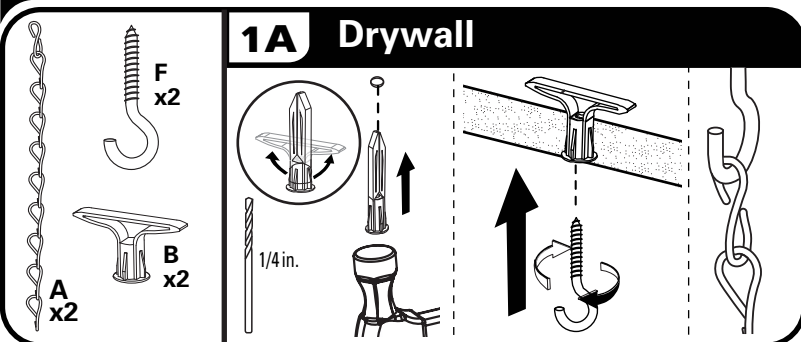

**1A DRYWALL INSTALLATION:** Mark 2 holes, 45 in. apart where the chains will be mounted. With a 1/16 in. Drill bit, drill a pilot hole at each mark. If no stud is encountered, use a 1/4 in. Drill bit and drill a hole for the ceiling anchors (B). Pinch the ceiling anchor (B) sides together and insert it into the hole. Push or tap the ceiling anchor (B) into place until the underside is against the ceiling. Install the screw hook (F) by rotating clock-wise. Determine the height the fixture will need to be suspended at. Insert the top loop of the of each chain (A) onto the mounting hooks (F).

**1B WOOD INSTALLATION:** Mark 2 holes, 45 in. apart where the chains will be mounted. With a 1/16 in. drill bit, drill a pilot hole at each mark. Install the screw hook (F) by rotating clock-wise. Determine the height the fixture will need to be suspended at. Insert the top loop of the of each chain (A) onto the mounting hooks (F).